

MINIATURE CHECK VALVES LTD

c/o Cambridge Reactor Design Ltd
Unit D2, Brookfield Business Centre
Twentypence Road,
Cottenham,
CB24 8PS,
England, UK

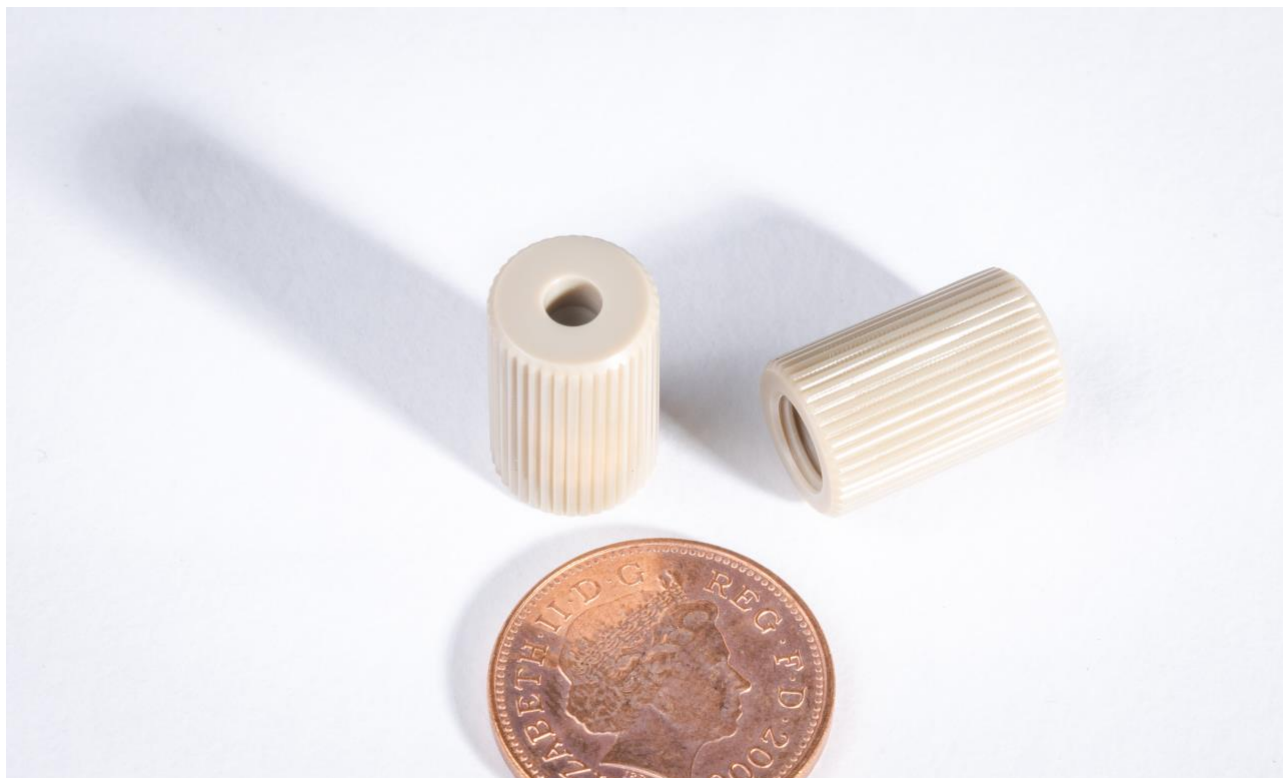

**PRODUCT
PART NUMBER**

**MINIATURE RELIEF VALVE IN PEEK
24040**

T 01954 252522 • **E** info@miniaturecheckvalves.com • **W** www.miniaturecheckvalves.com

COMPANY NUMBER 12867736 | VAT NUMBER GB357540388

Technical Information

Connectivity, both sides	UNF	¼-28
Material		PEEK
Total Pressure rating	Bar	5
Nominal flow of air with the pressure drop across the valve of 1 bar	nL/min	10
Nominal flow of water with the pressure drop across the valve of 1 bar	L/min	0.3
Spring material options		316 SS C22 C276
Cracking Pressure options	Bar	0.1 0.2 0.5 1 2
Seal options		EPDM FKM VMQ FFKM
Operating temperature range, FKM	C	-20C to 150C

Recommended fittings from IDEX

Fitting (P-331, 1/4-28 Peek Nut for 1/8" tubing)	Peek
Ferrule (P-359-Tefzel ferrule for 1/8 tubing)	Tefzel
Fitting (LT-115, 1/4-28 Peek Nut for 1/16" tubing)	Peek
Ferrule (P-248-Tefzel ferrule for 1/16 tubing)	Tefzel
Fitting (P-331, 1/4-28 Peek Nut for 2mm tubing)	Peek
Ferrule (P-355-KEL-F ferrule for 2mm tubing)	Kel-F

For Example Part Number = 24040-PEEK/PEEK-316-0.1BARG-FKM

(standard configuration is with 316 Stainless Steel Springs, Cracking Pressure of 0.1 Bar, FFKM Seal)

**CHECK VALVE PERFORMANCE DATA - 12110 [4mm]
AIR FLOW DATA AT 20C, CRACKING PRESSURE = 0.1 BARG**

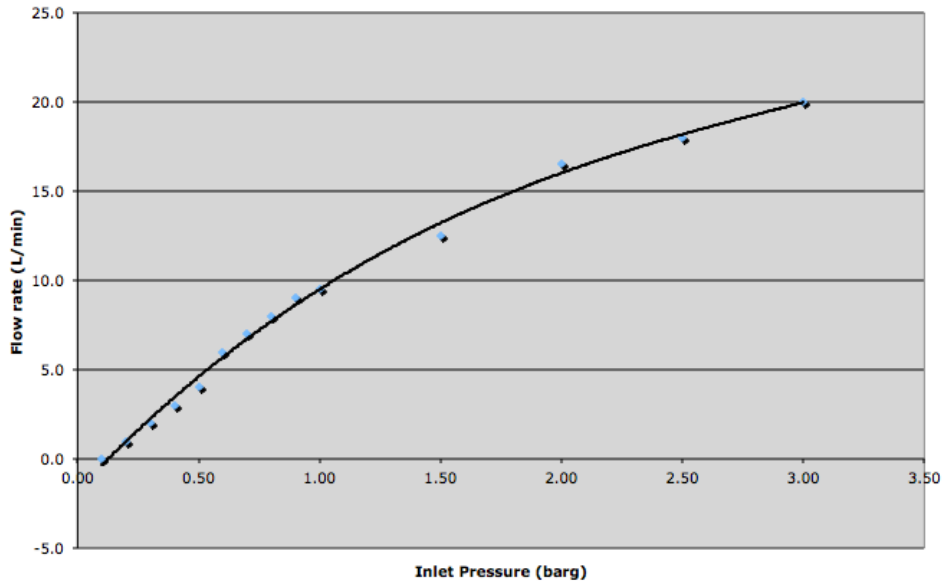

**CHECK VALVE PERFORMANCE DATA - 12110 (4mm)
WATER FLOW DATA AT 20C, CRACKING PRESSURE = 0.1 BARG**

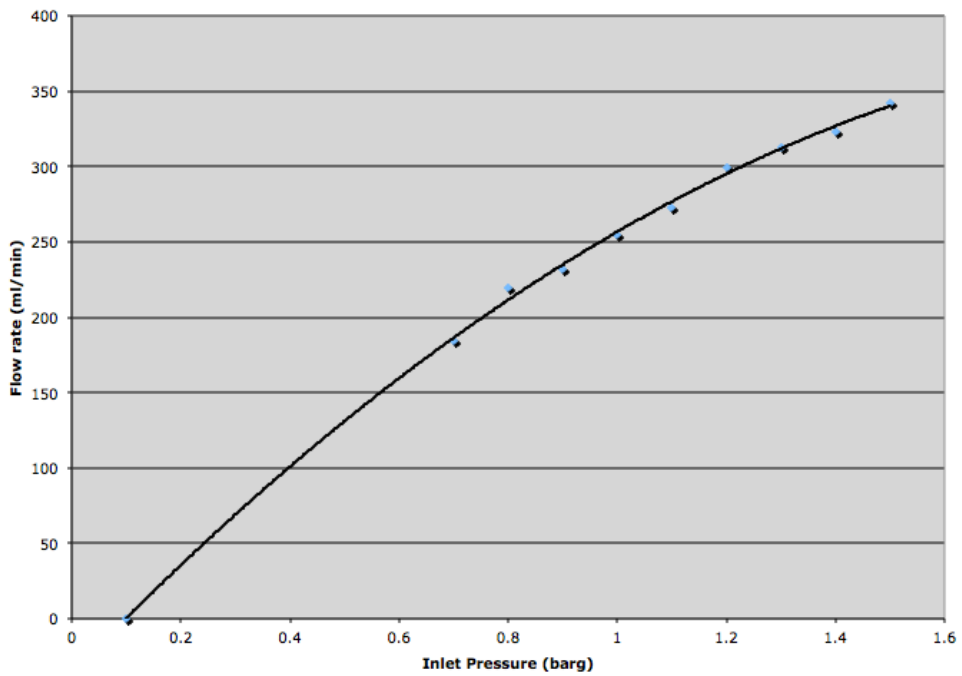

3RD ANGLE 

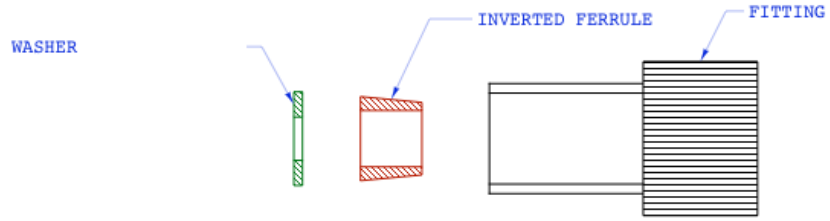

NOTE: IT IS VITAL THAT THE
INVERTED FERRULE IS INSERTED
AS SHOWN.

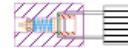
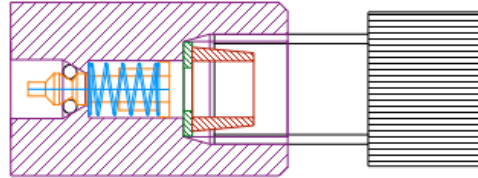

SIZE